



# MYK LATICRETE

  
**PROGRESSIVE  
ADHESIVE  
TECHNOLOGY  
IS HERE!**

## MYK LATICRETE 335 MAXI

**Now even the large tiles & stones  
will stay the way you want!**



This unique adhesive is specially formulated to flawlessly install very large format, thin body and laminate tiles & stones for interiors and exteriors.





### Why should you opt for large tiles:

It gives a tremendous sense of spaciousness • More hygiene • Proper fit for facades • Decreases installation time • Produces a continuity effect • Allows a wide variety of uses • They are in vogue

### MULTIPURPOSE LFT ADHESIVE 335 MAXI

This is a highly polymer modified and highly flexible adhesive for installation of large format/ slim tiles on most of the substrates to accommodate movements. It offers very good handling properties with good sag and slump resistance while doing installation on wall or floor respectively. It can be applied up to 18 mm bed thickness.

### Benefits:

- Light weight formula- 15% higher coverage than standard adhesive
- High strength with high polymer modification
- Good resistance against crack propagation
- Good impact resistance- provides cushion effect to tiles

### Suitable Tile Types:

- Slim porcelain large format tiles
- Vitreous, semi vitreous or non- vitreous tiles; ceramic; quarry, cement body tile
- Brick
- Cement based precast terrazzo
- Natural stone tile

### FEATURES

Extended open time

Non sag & non slump formula for large format tiles in wall and floor systems



### Applicable Standards:

- ANSI A118.4
- EN 12004 & ISO 13007
- IS15477:2019

### Working Properties at 70°F (21°C)

Pot Life	4-5 hours
Adjustment time	40-45 minutes
Open time	40-45 minutes
Time to foot traffic	16-24 hours

Specifications subject to change without notification. Results shown are typical but reflect test procedures used. Actual field performance will depend on installation methods and site conditions.

NOTE: For details on trowel notches & approximate coverage, Please refer the TDS of 335 Maxi.

Pack size: 25 kgs



# DIRECTIONS

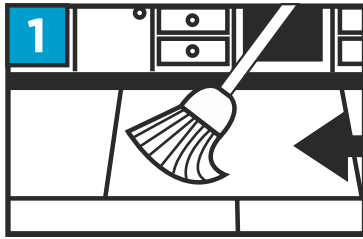

Remove all Dust, Water, Oil & Sealers from Surface

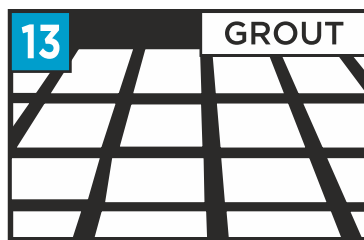
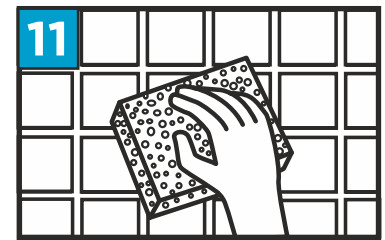
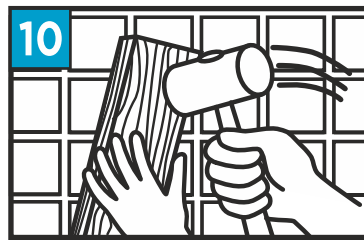
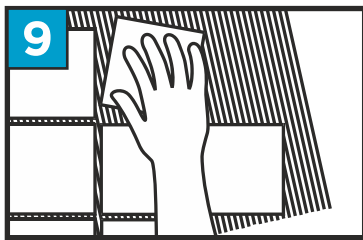
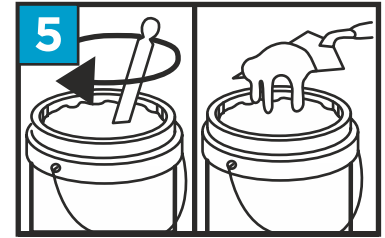
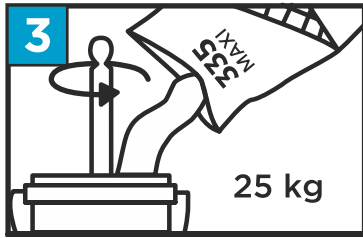
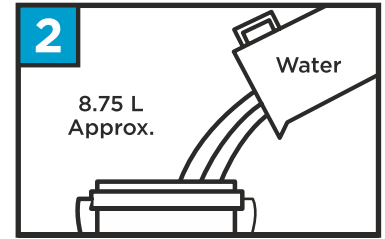

Scan here for product details



MYK LATICRETE

## MYK LATICRETE INDIA PVT. LTD.,

Registered Office: 8-2-703/A, 4th Floor, Leela Gopal Towers, Road No. 12, Banjara Hills, Hyderabad - 500 034  
 Ph: +91-40-6817 3100. e-mail: contact@myklaticrete.com www.myklaticrete.com  
 CIN: U99999TG1999PTC031624

Regional Offices: Ahmedabad: 093775 32991 | Bengaluru: 080-26757961 | Bhubaneshwar: 090780 85131 |  
 Chennai: 044-43518843 | Coimbatore: 0422-2644485 | Ghaziabad: 093506 21097 | Indore: 093015 32851 | Jaipur: 0141-  
 2210079 | Kochi: 0484-2577113 | Kolkata: 096810 75242 | Lucknow: 0522-4024125 | Ludhiana: 0161-2503686 | Mumbai:  
 022-26397453 | Nagpur: 093252 50899 | New Delhi: 011-43020146 | Panchkula: 0172-5033818 | Pune: 020-24213394 |  
 Vijayawada: 93967 07764 | Visakhapatnam: 07032640887.

Follow us on /myklaticreteindia /company/myk-laticrete-india-pvt-ltd /c/myklaticreteindia

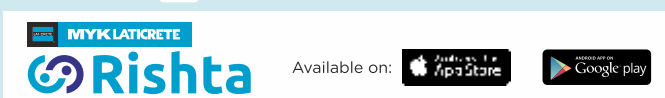

An MYK GROUP enterprise

The logo is Registered Trademark of LATICRETE International Inc.